



Flat

**3, SLOANE AVENUE,
SW3 3DW**

Per Month
£2,816

Available: 21st May 2026

FEATURES



Huddletons

1 Bedroom Flat located in London

Stylish 1-Bedroom Apartment in Iconic Chelsea Cloisters, South Kensington – Part Bills Included

Nestled in the heart of South Kensington, this beautifully presented 1-bedroom apartment is located within the sought-after Chelsea Cloisters – a secure, portered Art Deco building offering residents both peace of mind and prestige. Immaculately maintained and thoughtfully designed, the apartment combines classic charm with modern comforts, making it the perfect London base for professionals or couples. The bright living space features elegant furnishings, neutral décor, and large windows that allow for an abundance of natural light. The fully equipped kitchen and well-proportioned bedroom provide everything you need for comfortable city living.

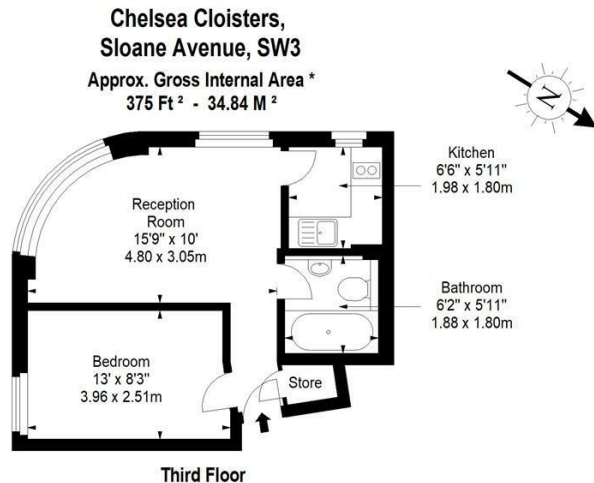

Every attempt has been made to ensure the accuracy of this floor plan however, measurements are approximate and for illustration purposes only. Measured in accordance with the RICS code of measuring practice. Not to scale

Call us on

0207 205 4411

info@huddletons.com

<http://www.huddletons.com>

Council Tax Band

C

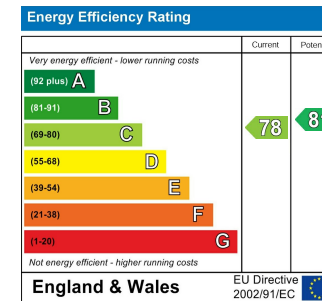

Agents Note: Whilst every care has been taken to prepare these particulars, they are for guidance purposes only. All measurements are approximate and are for general guidance purposes only and whilst every care has been taken to ensure their accuracy, they should not be relied upon and potential buyers are advised to recheck the measurements.

Huddletons